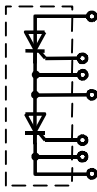
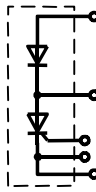
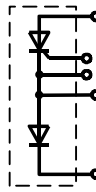

Thyristor/Diode Modules M## 320

Absolute Maximum Ratings

V_{RRM} V_{DRM} [V]	 MCC	 MCD	 MDC
3000	320-30io2	320-30io2	320-30io2
3200	320-32io2	320-32io2	320-32io2
3400	320-34io2	320-34io2	320-34io2
3600	320-36io2	320-36io2	320-36io2

	VOLTAGE RATINGS	MAXIMUM LIMITS	UNITS
V_{DRM}	Repetitive peak off-state voltage ¹⁾	3000 - 3600	V
V_{DSM}	Non-repetitive peak off-state voltage ¹⁾	3100 - 3700	V
V_{RRM}	Repetitive peak reverse voltage ¹⁾	3000 - 3600	V
V_{RSM}	Non-repetitive peak reverse voltage ¹⁾	3100 - 3700	V

	OTHER RATINGS	MAXIMUM LIMITS	UNITS
$I_{T(AV)M}$	Maximum average on-state current, $T_C = 85^\circ\text{C}$ ²⁾	327	A
$I_{T(AV)M}$	Maximum average on-state current, $T_C = 100^\circ\text{C}$ ²⁾	229	A
$I_{T(RMS)M}$	Nominal RMS on-state current, $T_C = 55^\circ\text{C}$ ²⁾	765	A
$I_{T(d.c.)}$	D.C. on-state current, $T_C = 55^\circ\text{C}$	624	A
I_{TSM}	Peak non-repetitive surge $t_p = 10$ ms, $V_{RM} = 60\%V_{RRM}$ ³⁾	5.0	kA
I_{TSM2}	Peak non-repetitive surge $t_p = 10$ ms, $V_{RM} \leq 10\text{V}$ ³⁾	5.5	kA
I^2t	I^2t capacity for fusing $t_p = 10$ ms, $V_{RM} = 60\%V_{RRM}$ ³⁾	125×10^3	A^2s
I^2t	I^2t capacity for fusing $t_p = 10$ ms, $V_{RM} \leq 10\text{V}$ ³⁾	150×10^3	A^2s
$(di/dt)_{cr}$	Critical rate of rise of on-state current (non-repetitive) ⁴⁾	400	$\text{A}/\mu\text{s}$
V_{RGM}	Peak reverse gate voltage	5	V
$P_{G(AV)}$	Mean forward gate power	4	W
V_{ISOL}	Isolation Voltage ⁵⁾	3000	V
	Isolation Voltage ⁶⁾	3600	V
$T_{vj\ op}$	Operating temperature range	-40 to +125	$^\circ\text{C}$
T_{stg}	Storage temperature range	-40 to +125	$^\circ\text{C}$

Notes:

- 1) De-rating factor of 0.13% per $^\circ\text{C}$ is applicable for T_v below 25°C .
- 2) Single phase; 50 Hz, 180° half-sinewave.
- 3) Half-sinewave, 125°C T_{vj} initial.
- 4) $V_D = 67\% V_{DRM}$, $I_{FG} = 2$ A, $t_r \leq 0.5\mu\text{s}$, $T_C = 125^\circ\text{C}$.
- 5) AC RMS voltage, 50 Hz, 1 minute test
- 6) AC RMS voltage, 50 Hz, 1 second test

Characteristics

	PARAMETER	MIN.	TYP.	MAX.	TEST CONDITIONS ¹⁾	UNITS
V_{TM}	Maximum peak on-state voltage	-	-	2.20	$I_{TM} = 785 \text{ A}$, $T_{vj} = 25^\circ\text{C}$	V
V_{TO}	Threshold voltage	-	-	1.15		V
r_T	Slope resistance	-	-	0.80		m Ω
$(dv/dt)_{cr}$	Critical rate of rise of off-state voltage	1000	-	-	$V_D = 67\% V_{DRM}$, linear ramp, Gate o/c	V/ μs
I_{DRM}	Peak off-state current	-	-	200	Rated V_{DRM}	mA
I_{RRM}	Peak reverse current	-	-	200	Rated V_{RRM}	mA
V_{GT}	Gate trigger voltage	-	-	2.50	$T_{vj} = 25^\circ\text{C}$, $V_D = 12 \text{ V}$, $I_T = 3 \text{ A}$	V
I_{GT}	Gate trigger current	-	-	250		mA
V_{GD}	Gate non-trigger voltage	0.35	-	-	$67\% V_{DRM}$	V
I_{GD}	Gate non-trigger current	15	-	-	$67\% V_{DRM}$	mA
I_L	Latching current	-	-	1000	$V_D = 12 \text{ V}$, $T_{vj} = 25^\circ\text{C}$	mA
I_H	Holding current	-	-	300	$V_D = 12 \text{ V}$, $T_{vj} = 25^\circ\text{C}$	mA
t_{gd}	Gate controlled turn-on delay time	-	-	3.0	$I_{FG} = 2 \text{ A}$, $di_g/dt = 1 \text{ A}/\mu\text{s}$, $V_D = 40\% V_{DRM}$, $I_{TM} = 320 \text{ A}$, $di/dt = 10 \text{ A}/\mu\text{s}$, $T_{vj} = 25^\circ\text{C}$	μs
t_q	Turn-off time	-	-	320	$I_{TM} = 320 \text{ A}$, $di/dt = 10 \text{ A}/\mu\text{s}$, $V_R = 100 \text{ V}$, $V_{DR} = 67\% V_{DRM}$, $dv_{DR}/dt = 50 \text{ V}/\mu\text{s}$	μs
R_{thJC}	Thermal resistance, junction to case	-	-	0.0650	Per arm	K/W
		-	-	0.0325	Whole Module	K/W
R_{thCH}	Thermal resistance, case to heatsink	-	-	0.0200	Per arm	K/W
		-	-	0.0100	Whole Module	K/W
F_1	Mounting force (to heatsink)	5.1	-	6.9		Nm
F_2	Mounting force (to terminals)	10.8	-	13.2	²⁾	Nm
W_t	Weight	-	1.5	-		kg

Notes:

- 1) Unless otherwise indicated $T_{vj} = 125^\circ\text{C}$.
- 2) Screws must be lubricated.

Outline Drawing & Ordering Information

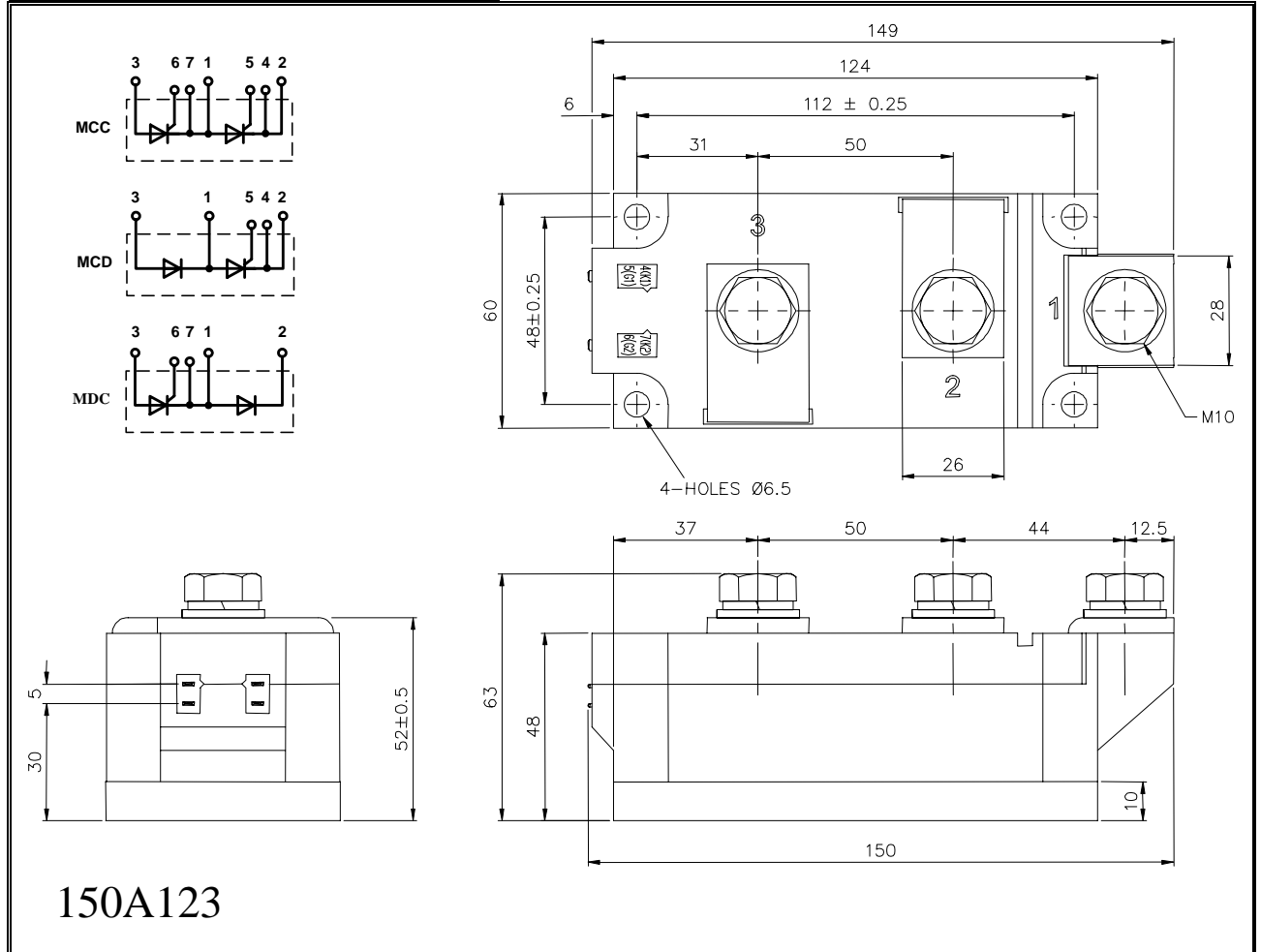

150A123

ORDERING INFORMATION

(Please quote 11 digit code as below)

M	##	320	◆◆	io	2
Fixed Type Code	Configuration code CC, CD or DC	Fixed Type Code	Voltage code $V_{RRM}/100$ 30-36	i = Critical dv/dt 1000 V/μs o = Typical turn-off time	Fixed Version Code

Typical order code: MCC320-36io2– MCC configuration, 3600V V_{RRM}

IXYS Semiconductor GmbH
Edisonstraße 15
D-68623 Lampertheim
Tel: +49 6206 503-0
Fax: +49 6206 503-627
E-mail: marcom@ixys.de



www.ixys.com

Westcode Semiconductors Ltd
Langley Park Way, Langley Park,
Chippenham, Wiltshire, SN15 1GE.
Tel: +44 (0)1249 444524
Fax: +44 (0)1249 659448
E-mail: WSL.sales@westcode.com

IXYS Corporation
1590 Buckeye Drive
Milpitas CA 95035 7418 USA
Tel: +1 (408) 547 9000
Fax: +1 (408) 496 0670
E-mail: sales@ixys.net



An IXYS Company

www.westcode.com

IXYS Long Beach, Inc
2500 Mira Mar Ave, Long Beach
CA 90815 USA
Tel: +1 (562) 296 6584
Fax: +1 (562) 296 6585
E-mail: service@ixyslongbeach.com

The information contained herein is confidential and is protected by Copyright. The information may not be used or disclosed except with the written permission of and in the manner permitted by the proprietors IXYS Semiconductors GmbH.
In the interest of product improvement, IXYS reserves the right to change specifications at any time without prior notice.

© IXYS Semiconductor GmbH.